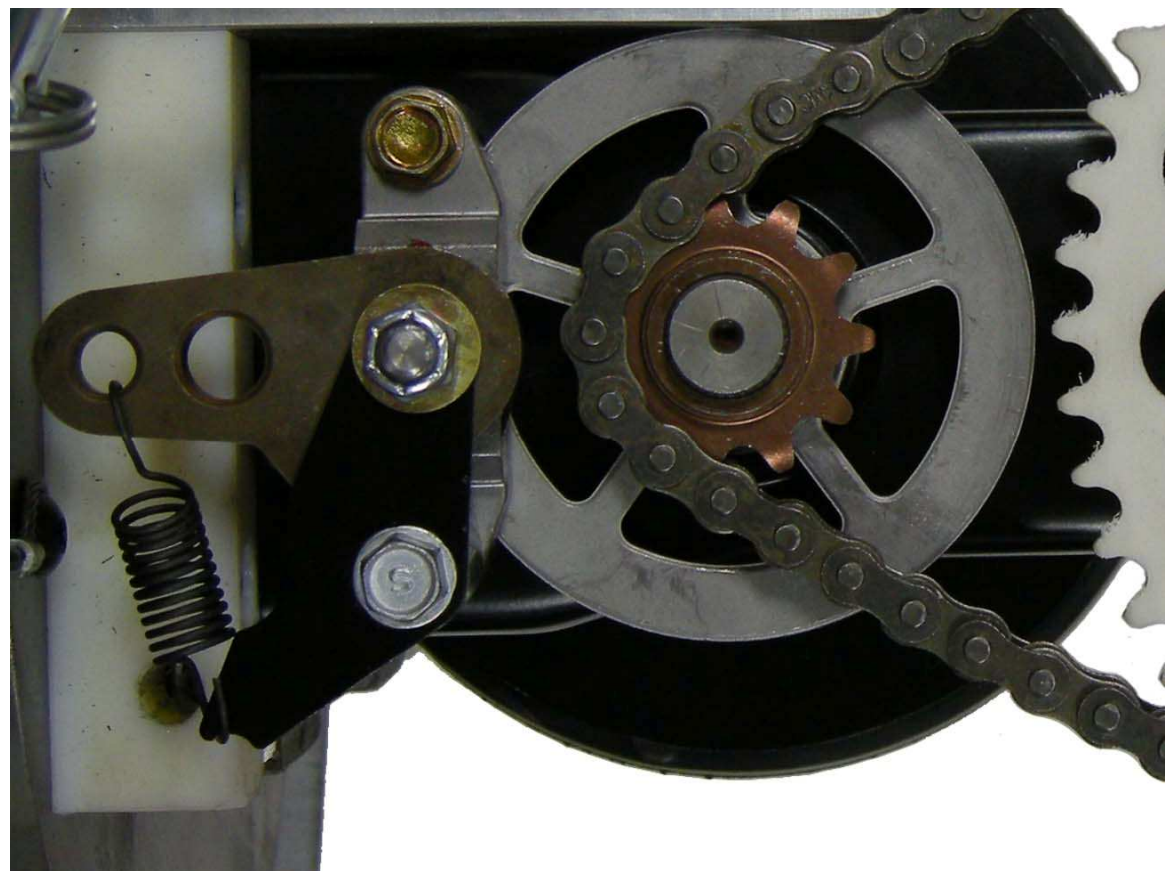

Main Menu

- [Brake Puck Replacement](#)
- [Brake Adjustment](#)
- [Clutch / Brake Cable Replacement](#)

[PRIMARY MENU](#)[LRV MENU](#)

Brake Disassembly and Brake Puck

- The brake assembly can be partially disassembled.

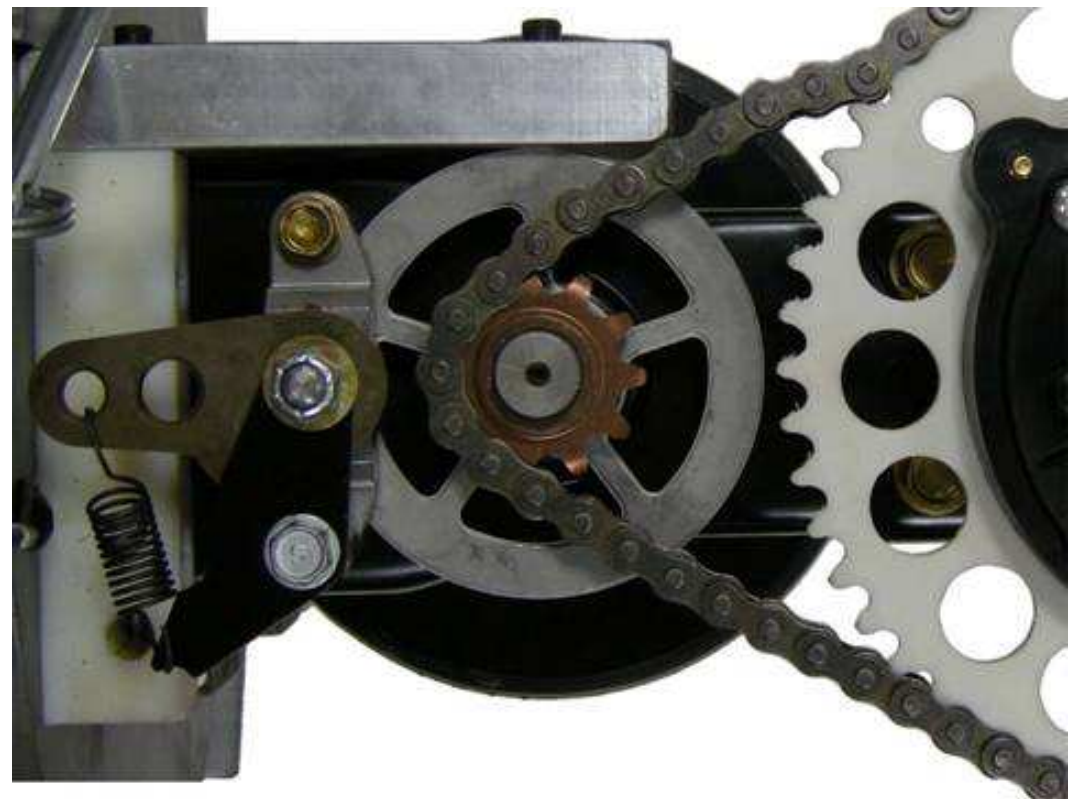

[RETURN TO
MAIN MENU](#)

Brake Disassembly and Brake Puck

DIFFERENTIAL CHAIN

BRAKE ASM CALIPER

- The brake rotor and inner brake puck are not accessible unless the differential chain is removed.
- At this time the transmission is replaced as an assembly. This includes the brake.

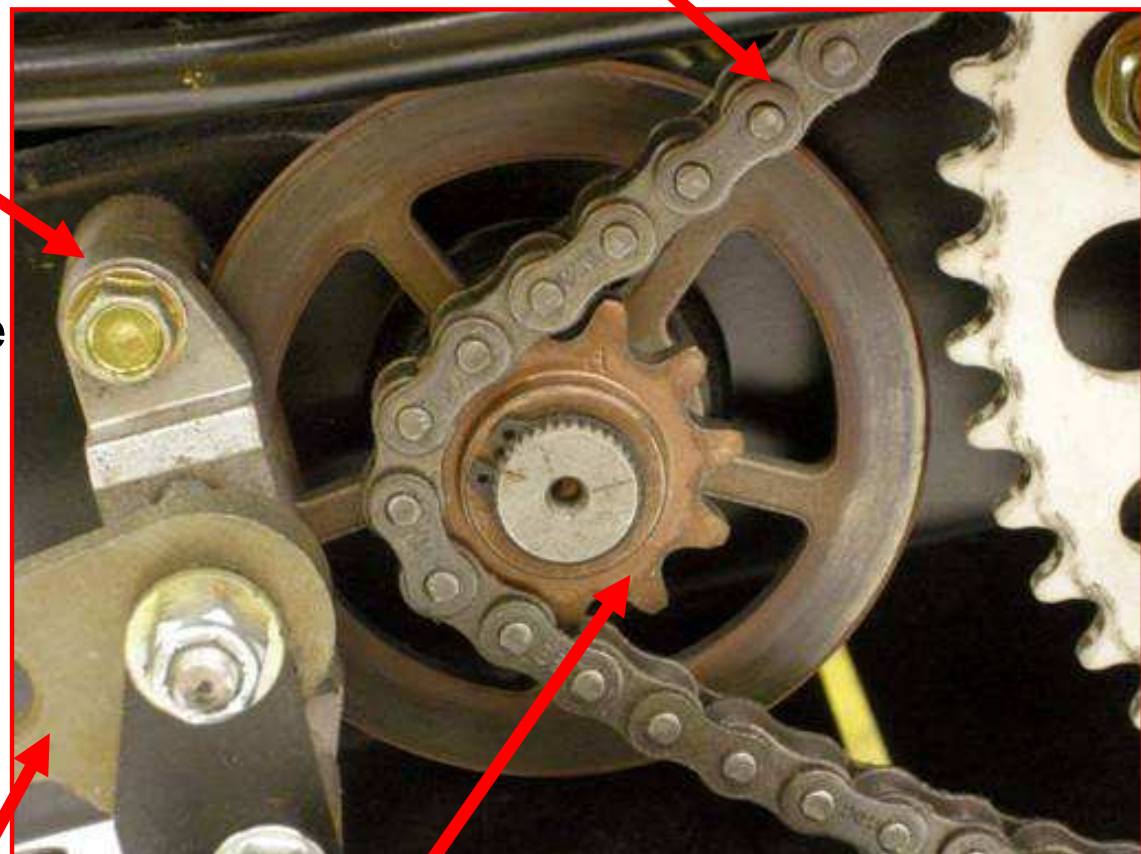

BRAKE ARM

SPROCKET FOR
DIFFERENTIAL CHAIN[RETURN TO
MAIN MENU](#)

Brake Disassembly and Brake Puck

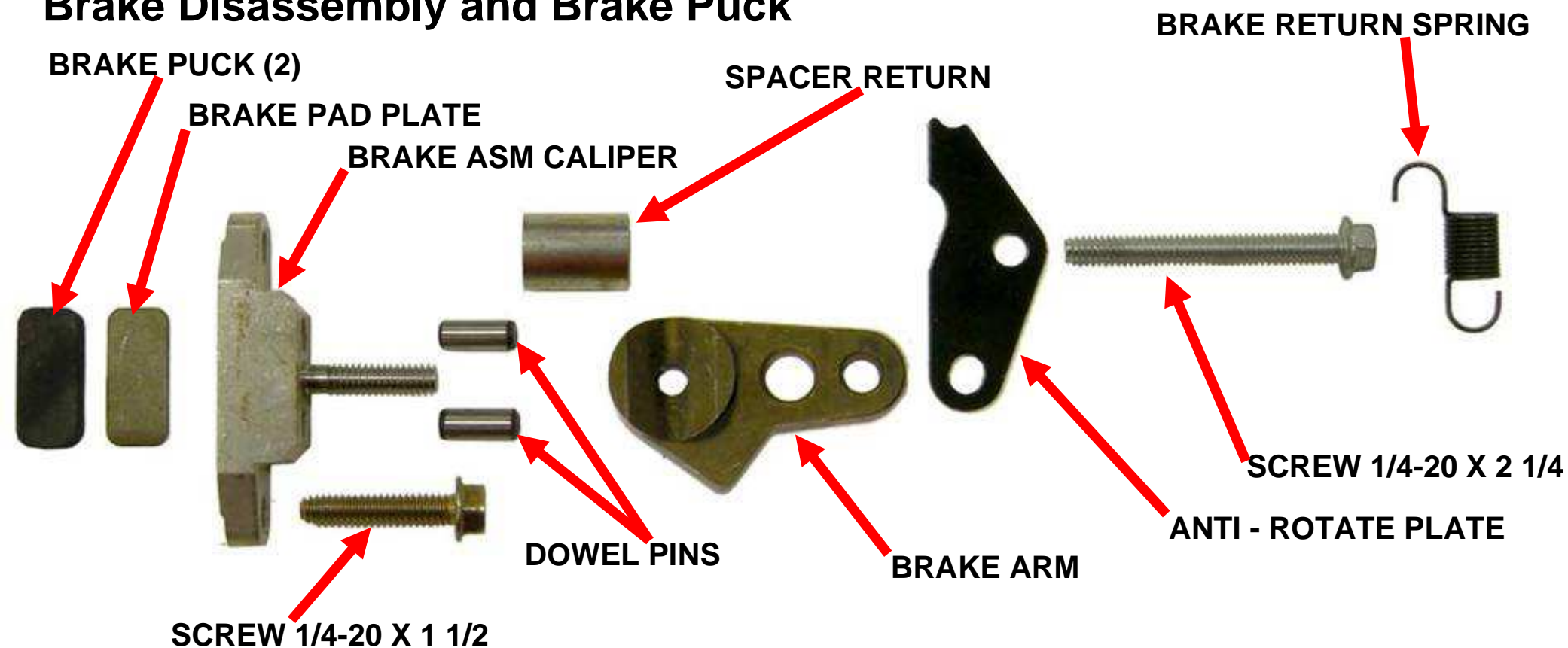

- The brake parts are assembled in this sequence.

[RETURN TO
MAIN MENU](#)

Brake Disassembly and Brake Puck

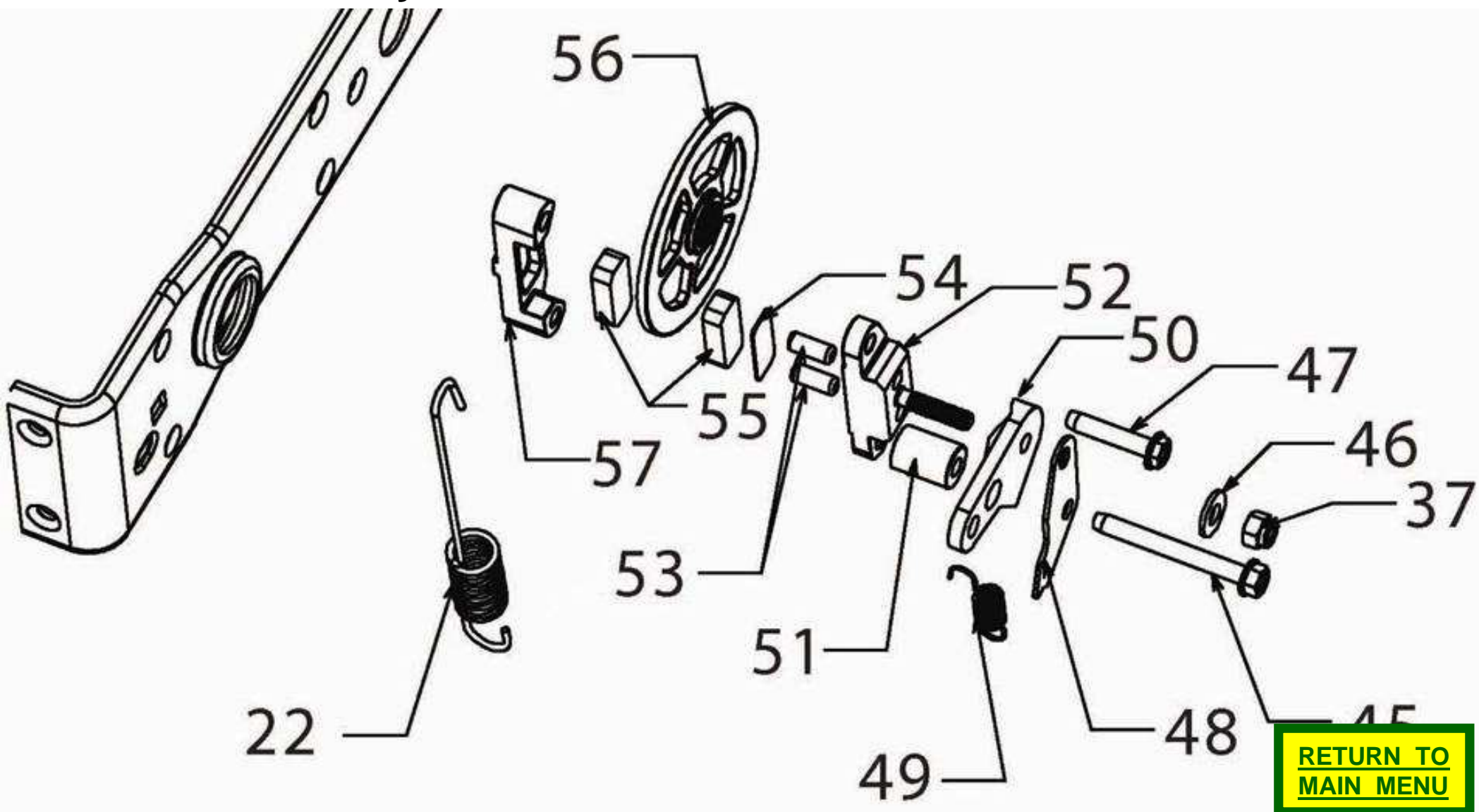

[RETURN TO MAIN MENU](#)

Brake Disassembly and Brake Puck

- Install the washer and the brake adjustment nut.

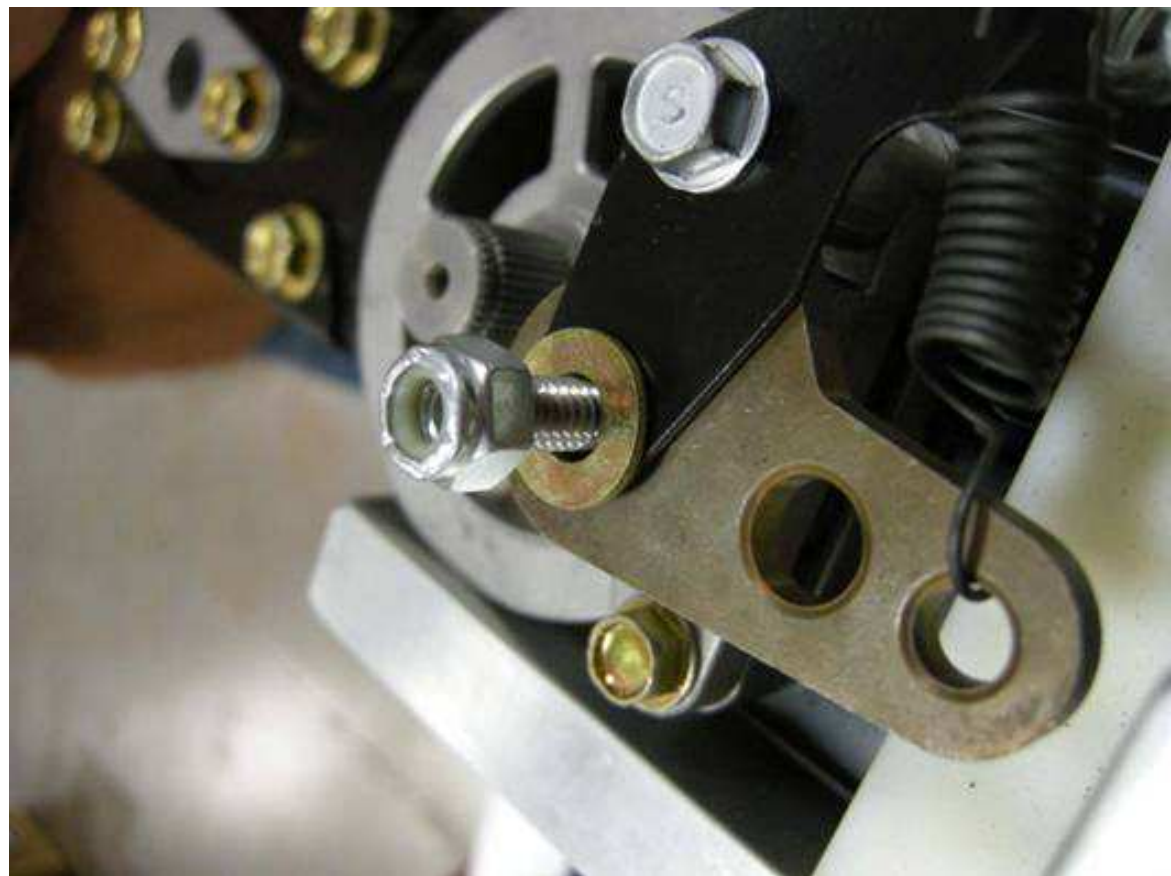

[RETURN TO
MAIN MENU](#)

Brake Disassembly and Brake Puck

- When completed the brake parts should be assembled as shown.
- Proceed to the brake adjustment procedure.

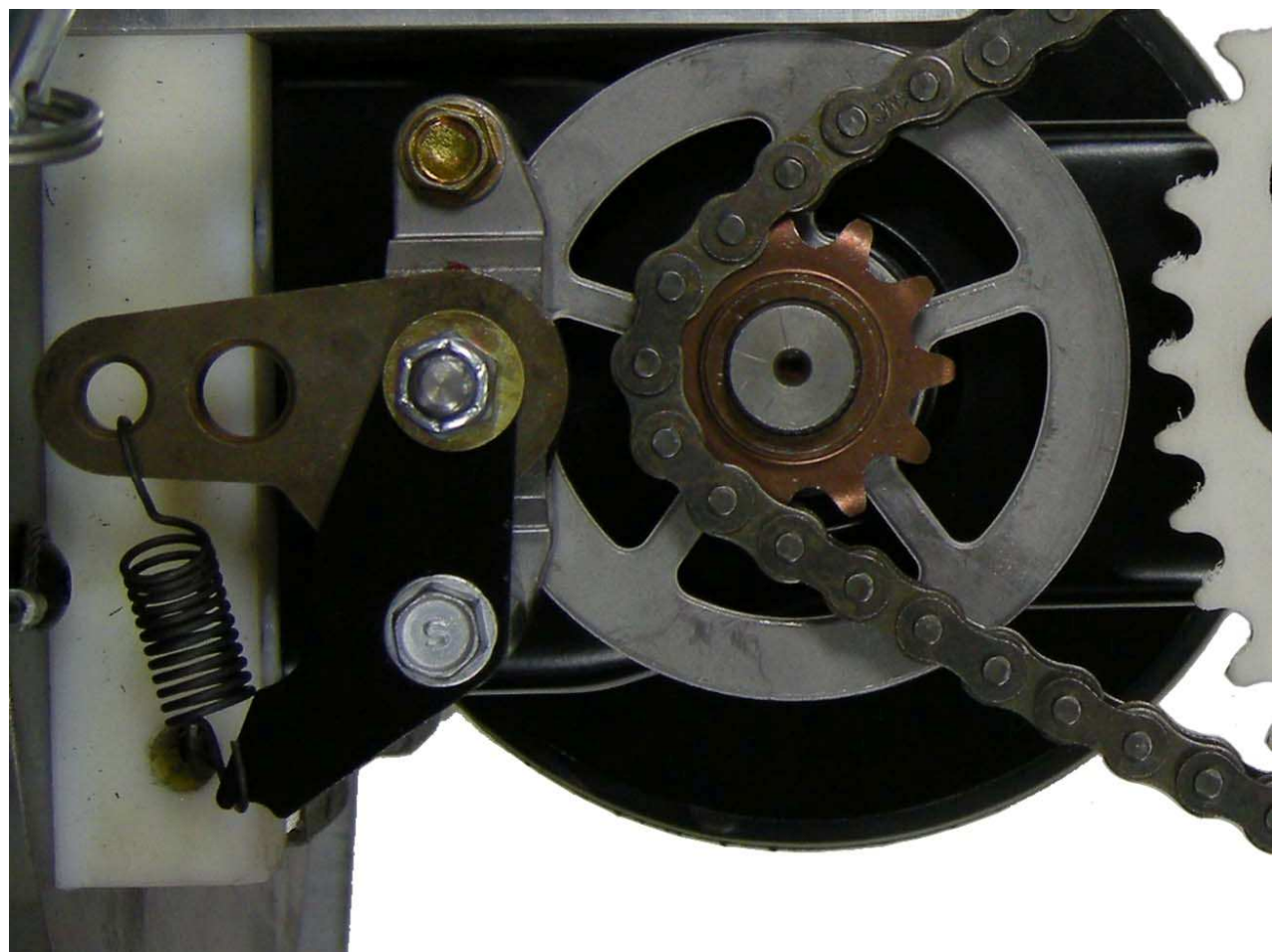

[RETURN TO
MAIN MENU](#)

Brake Adjustment

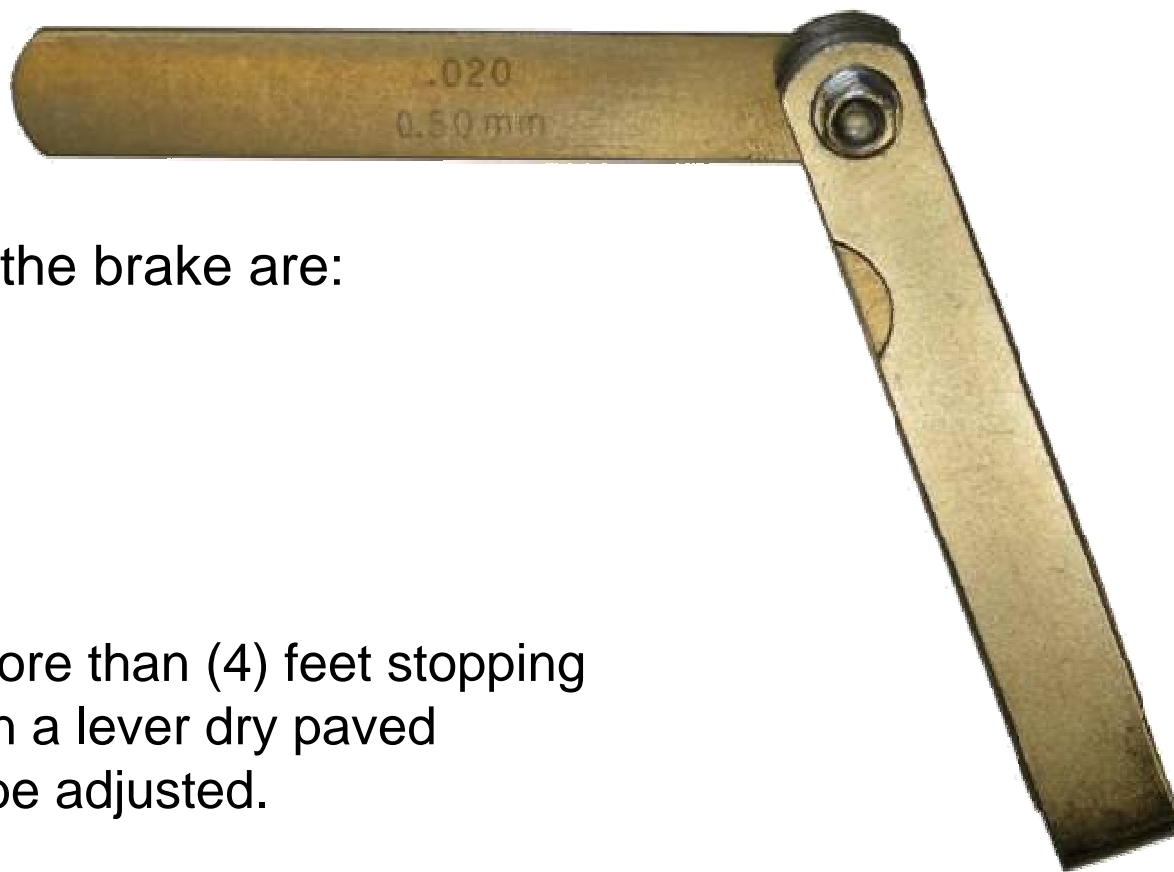

The tools required to adjust the brake are:

- .020" feeler gauge
- 7/16" open end wrench
- If riding mower requires more than (4) feet stopping distance in highest gear on a level dry paved surface, then brake must be adjusted.

[RETURN TO
MAIN MENU](#)

Brake Adjustment

- Park the LRV on a level surface.
- Release the brake.
- Remove the engine guard and the rear plate from the LRV.

ENGINE GUARD



REAR PLATE

[RETURN TO
MAIN MENU](#)

Brake Adjustment

- Loosen the adjustment nut.
- Insert the .020" feeler gauge between the brake disc and a friction puck.
- Tighten the adjustment nut
- Remove the feeler gauge.

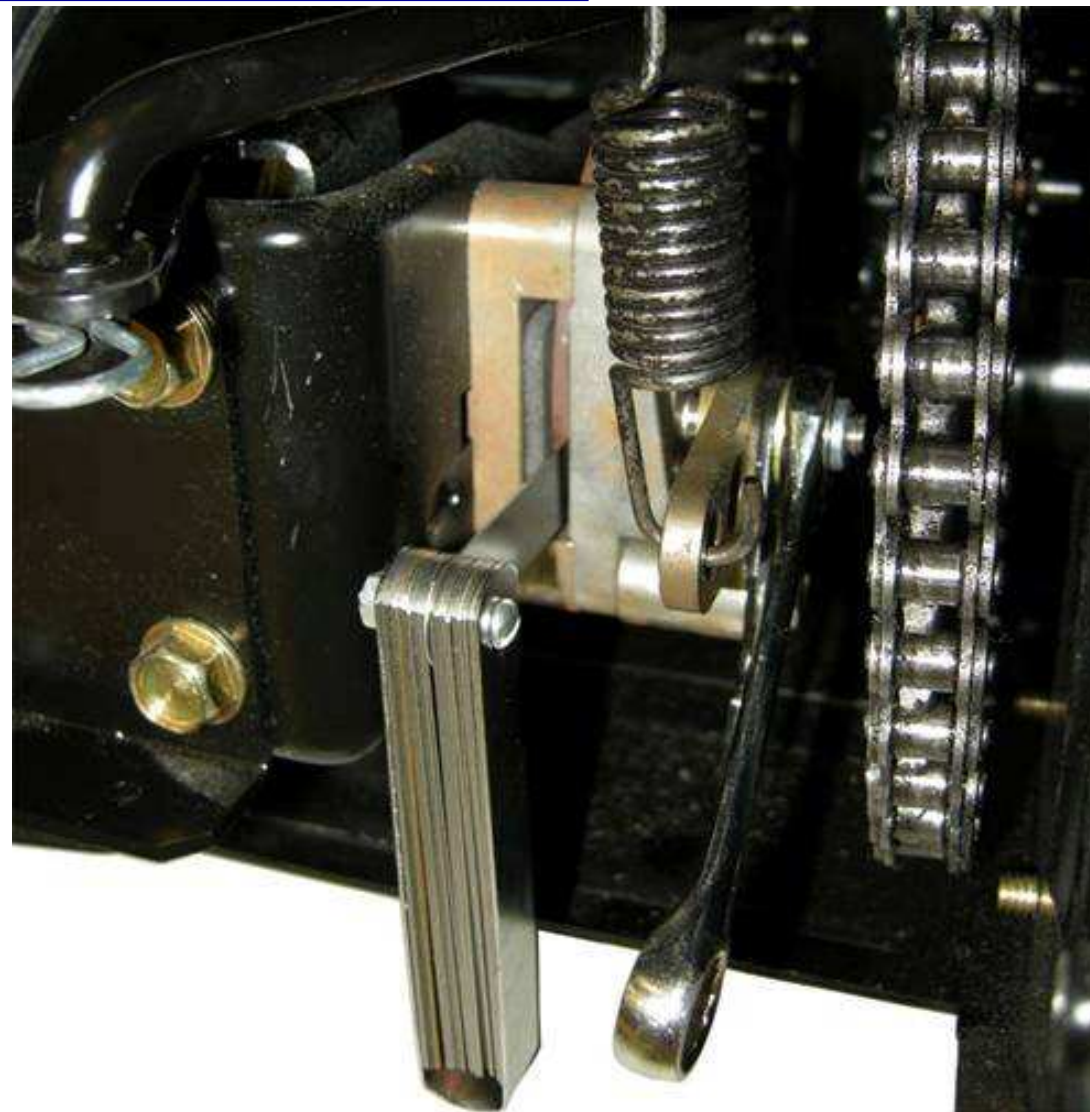

[RETURN TO
MAIN MENU](#)

Brake Adjustment

- Make sure the brake spring and the brake return spring are in place.
- Reassemble the rear plate and the engine guard to the chassis.
- Test the brakes. The LRV should stop within 4 feet on a level paved surface.

428076 BRAKE SPRING

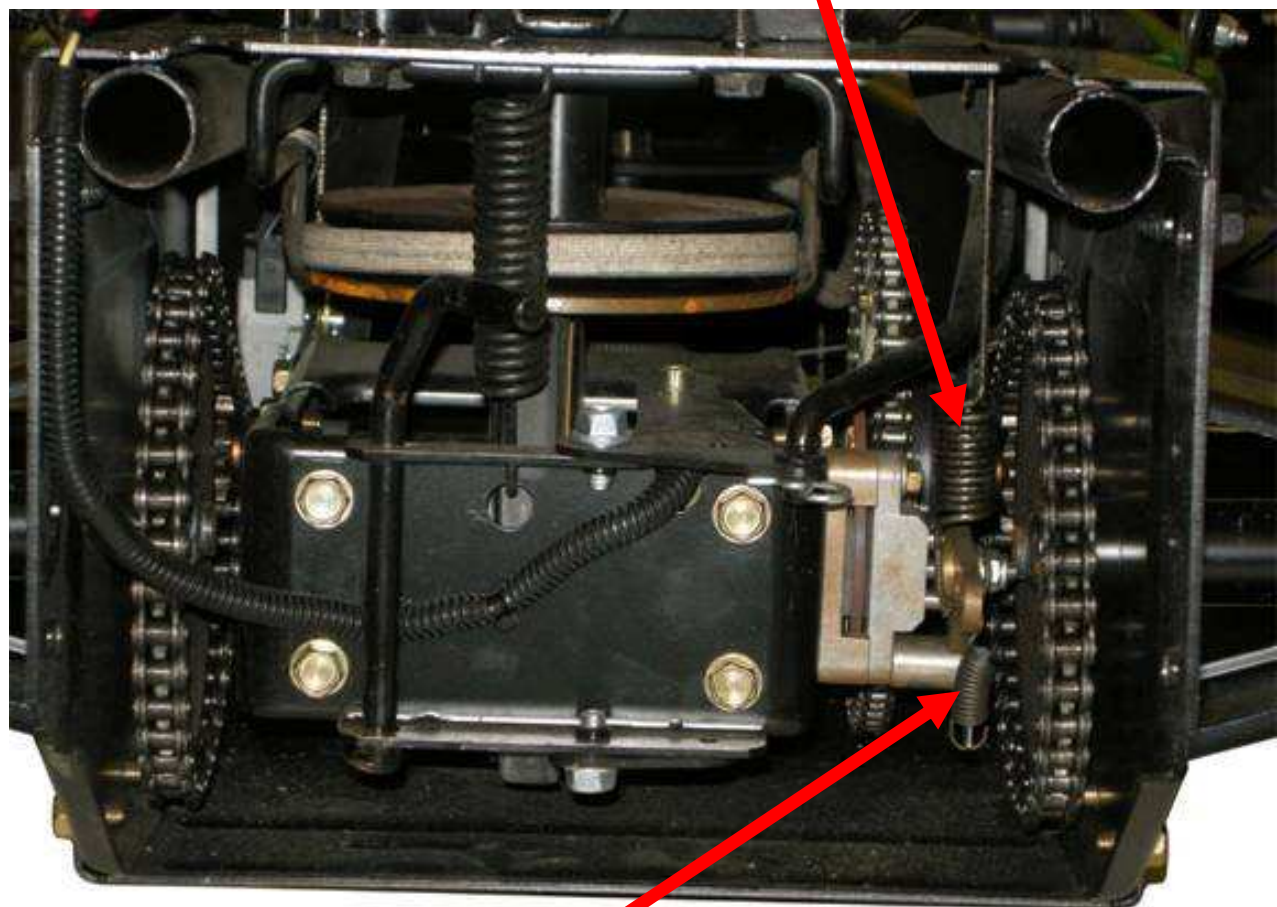

430245 BRAKE RETURN SPRING

[RETURN TO
MAIN MENU](#)

Clutch / Brake Cable

To access the front attachment point for the brake cable, remove the:

- steering wheel and the
- dust boot.

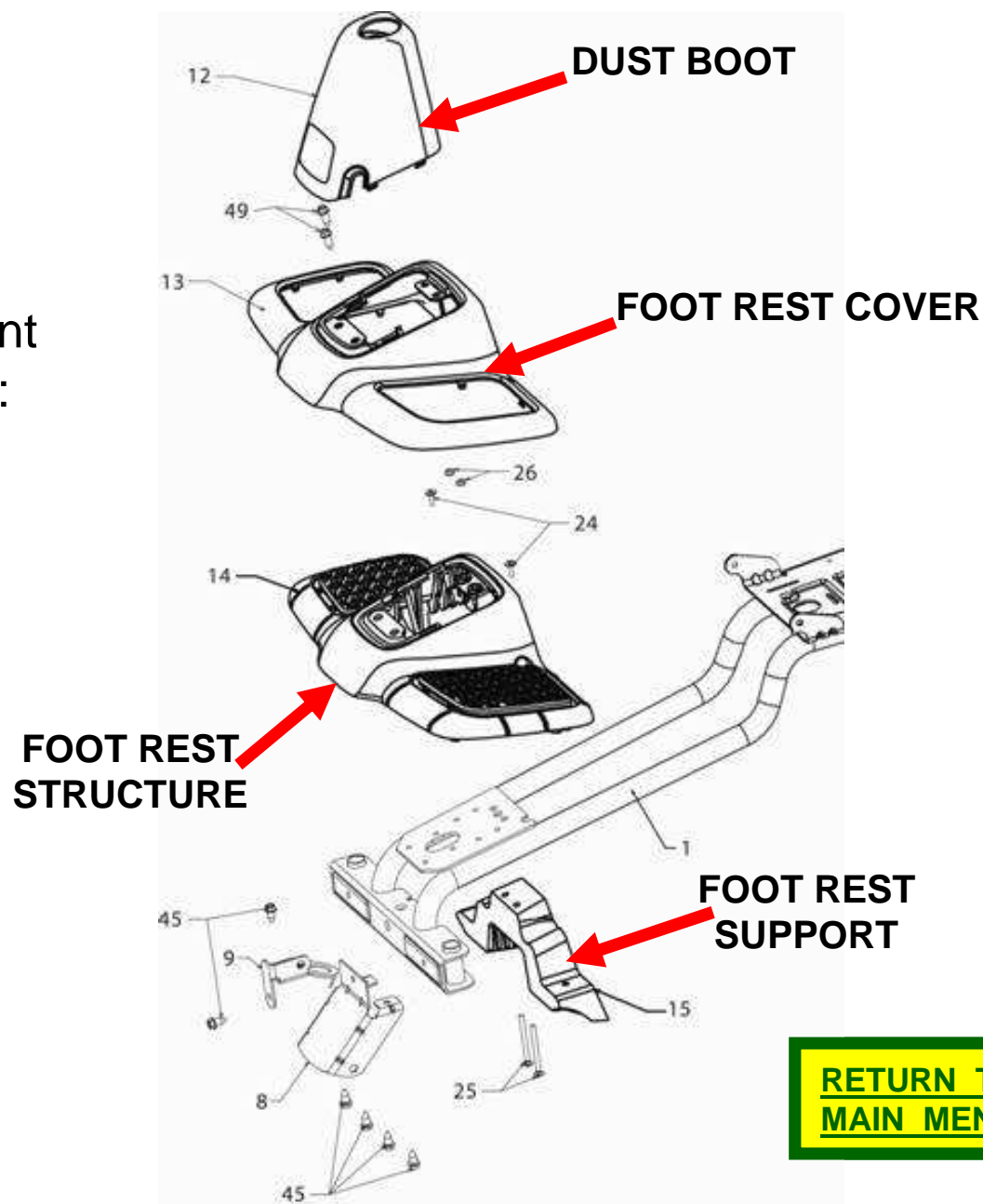

[RETURN TO
MAIN MENU](#)

Clutch / Brake Cable

- The brake cable conduit snaps into a bracket.
- Use a new cotter pin to attach the end of the cable to the bracket on the clutch / brake shaft.

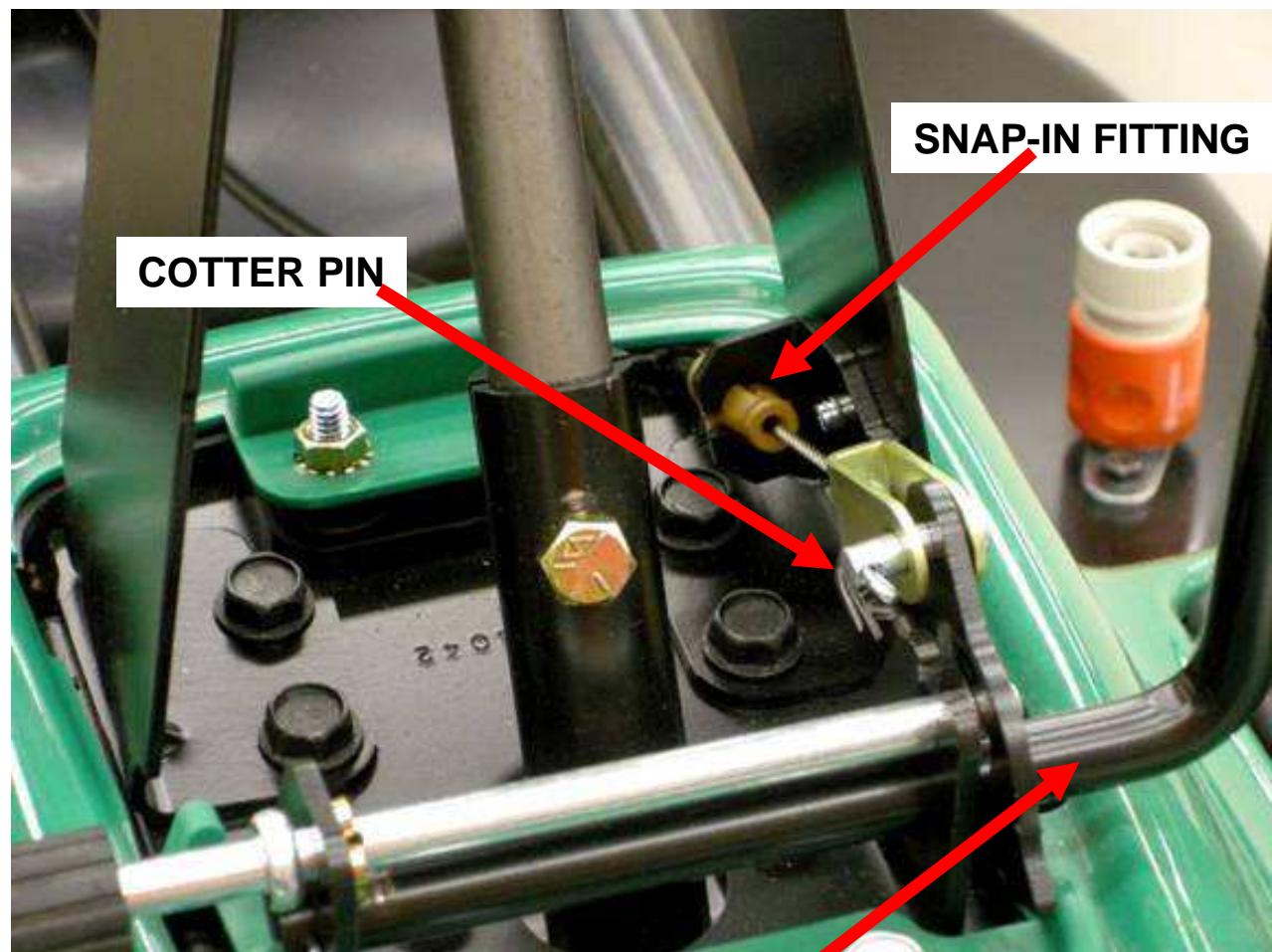

CLUTCH / BRAKE PEDAL SHAFT

[RETURN TO
MAIN MENU](#)

Clutch / Brake Cable

BRAKE CABLE

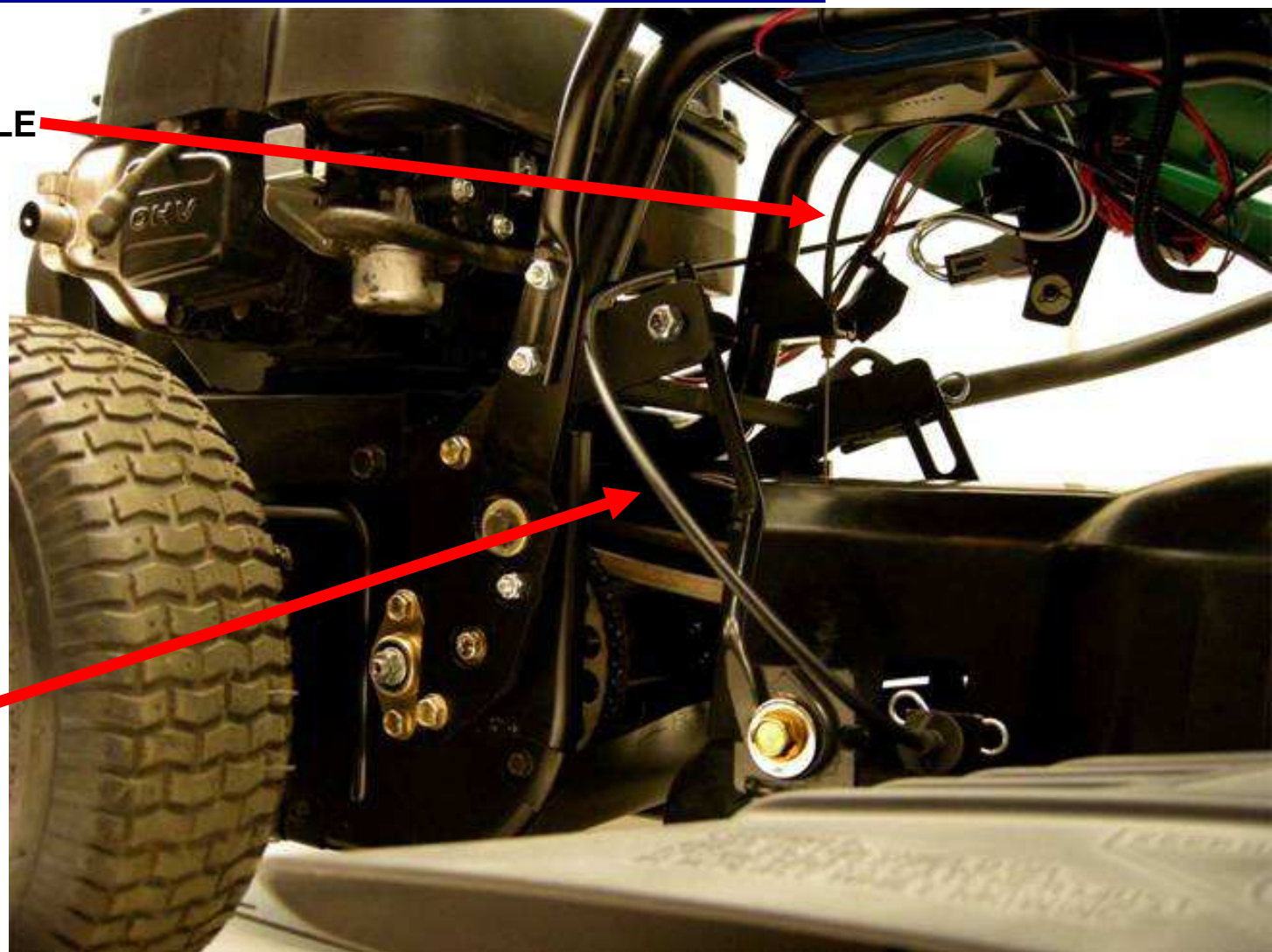
MOWER
ENGAGEMENT
CABLE

- Follow the brake cable. It is attached to the transmission behind the left rear corner of the operators seat.

[RETURN TO
MAIN MENU](#)

Clutch / Brake Cable

- The brake cable attaches to the transmission next to the clutch / brake interlock switch.
- Test brake operation after the new cable is installed.
- The LRV must stop within four feet from the fastest speed on a level paved surface.



[RETURN TO
MAIN MENU](#)

Brake Cable

THE END

[PRIMARY MENU](#)

[LRV MENU](#)

[RETURN TO
MAIN MENU](#)

Content:

- Focus on new technology
- Only include what the tech DOES NOT know
- Ordered in logical sequence of steps

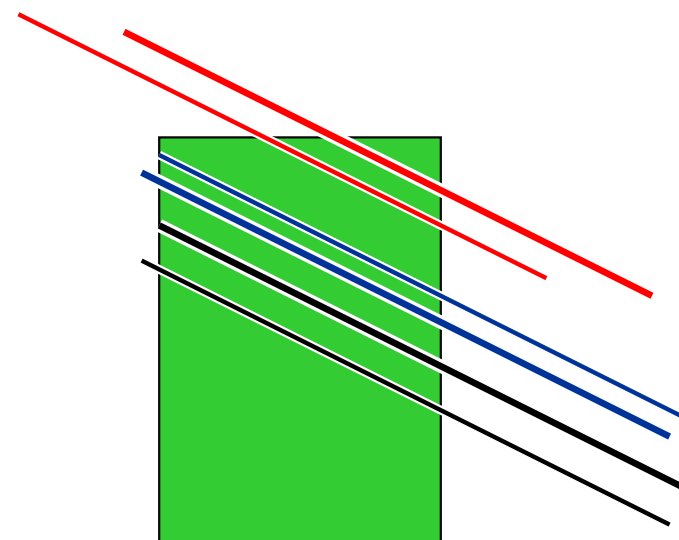
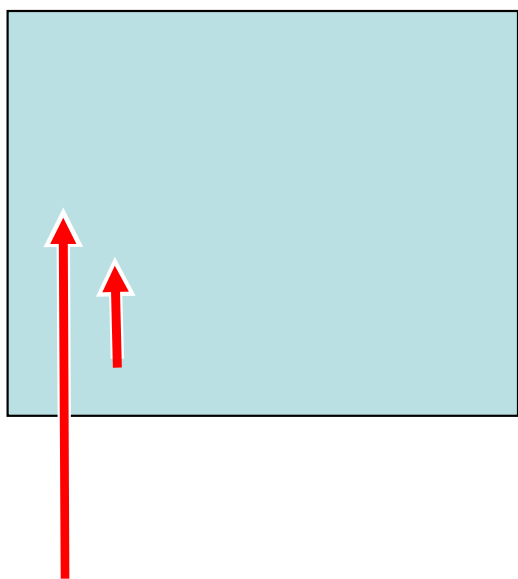

ILLUSTRATION NOTE

RETURN TO
MAIN MENU