

FRONT WHEEL ALIGNMENT (TOE IN OR TOE OUT) ISSUES ON TRACTORS

If a tractor comes in with the non adjustable dual drag links (not drag link and tie rod setup and the toe in cannot be adjusted to the 1/8" to 1/4" toe in as specified, there is an adjustable set to replace the non adjustable stock units.

The part #s are:

AY-409600 for the R/H side and

AY-409599 for the L/H side

The Cast Iron Axle Spindle Nyliners are never shown on any IPLs and the Part # is AY- 406013 (4 per axle)

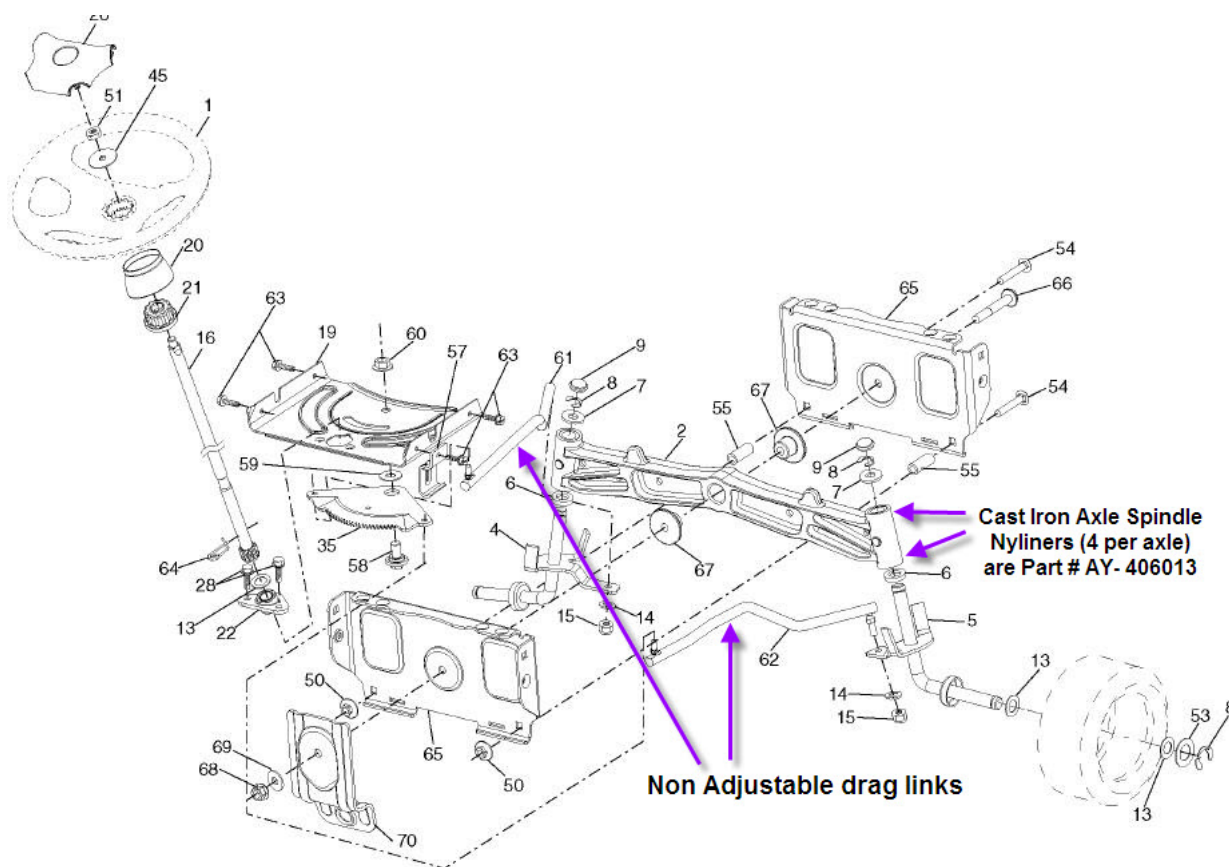

[Back to Home Page](#)

