

944.621431

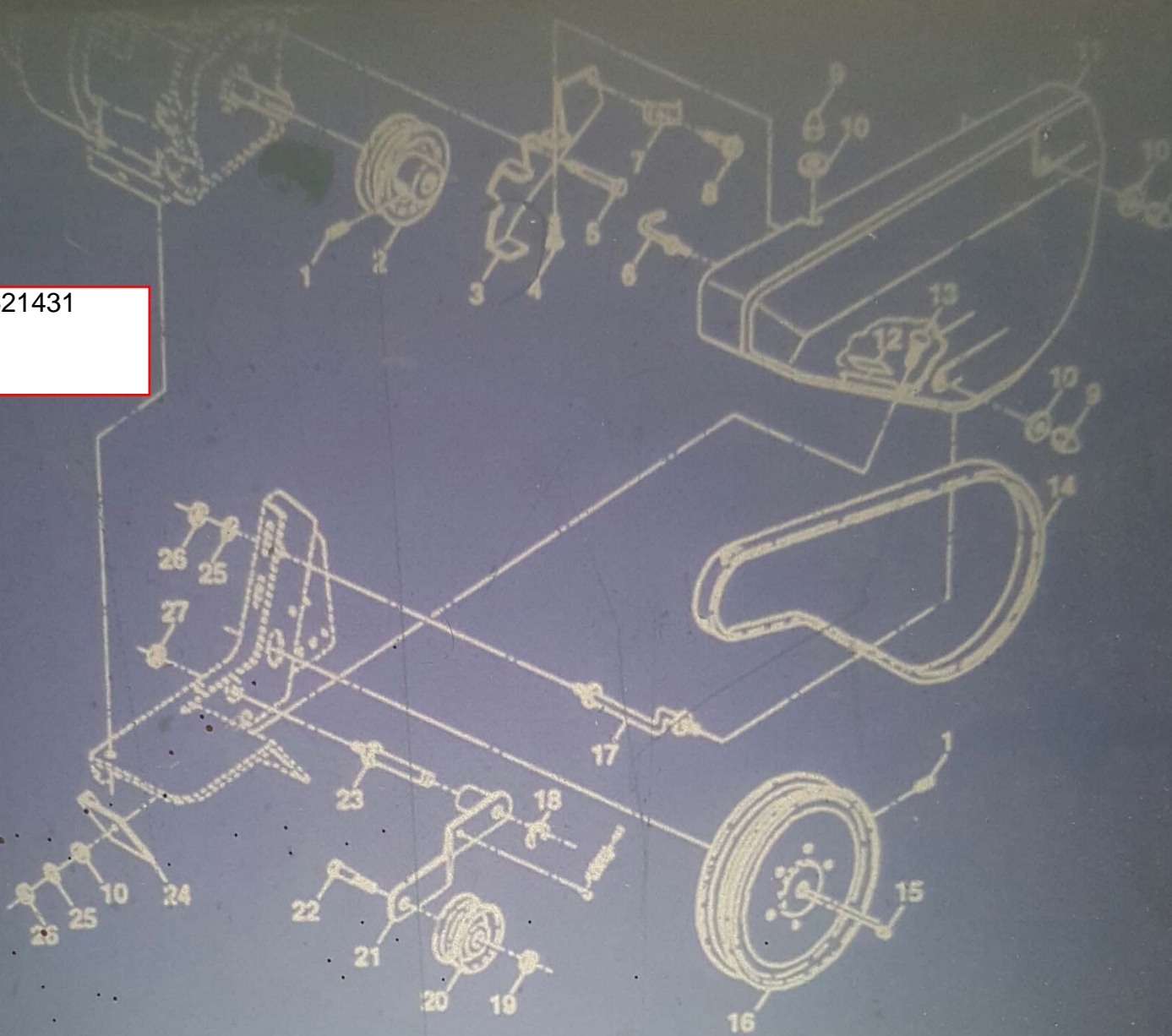

KEY NO.	PART NO.	DESCRIPTION
1	STD503103	*Screw, Set, Forged Socket, Headless 5/16-18 x 3/8
2	130811	Pulley, Engine
3	122955X	Bracket Assembly, Guard, Belt
4	STD532505	*Bolt, Carriage 1/4-20 x 1/2
5	74770812	Bolt, Hex 1/2-20 x 3/4
6	121463X	Keeper, Belt, Transmission Pulley
7	9484R	Clip
8	86777	Screw, Hex, Washer Hd., Slotted, Thread #10-24 x 1/2 Type D
9	104213X	Nut, Cap 1/4-20
10	STD551025	*Washer 9/32 x 5/8 x 16 Ga.
11	131157X417	Guard, Belt
12	109227X	Pad, Idler
13	STD532507	*Bolt, Carriage 1/4-20 x 3/4
14	9178R	V-Belt
15	2649M	Key, Square
16	9174R	Pulley, Transmission

KEY NO.	PART NO.	DESCRIPTION
17	132213	Bolt, Belt Guard
18	12000036	Ring, Clip
19	STD541237	*Nut, Hex, Jam 3/8-16
20	9178R	Pulley, Idler
21	6744A30	Idler Arm Assembly
22	STD523712	*Bolt, Hex 3/8-16 x 1-1/4
23	106968X	Shaft, Idler Arm
24	105258X	Shield, Dirt
25	STD551125	*Washer Lock 1/4
26	STD541025	*Nut, Hex 1/4-20
27	STD541031	*Nut, Hex, Jam 5/16-18
--	132951	Decal (Belt Guard)

*STANDARD HARDWARE — PURCHASE LOCAL
 NOTE: All component dimensions given in U.S. in
 1 inch = 25.4 mm

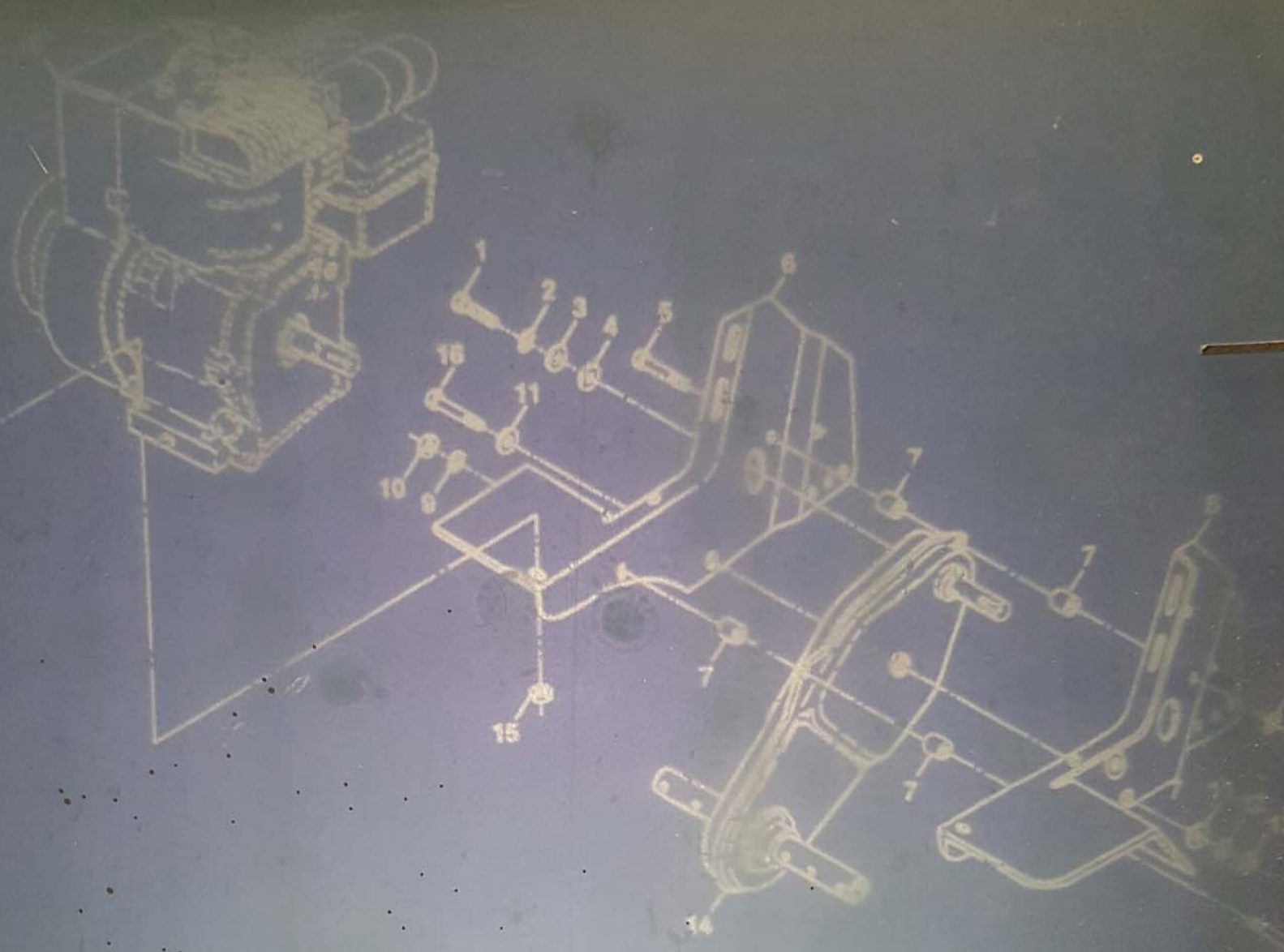

PART NO.	DESCRIPTION
74610412	Bolt, Hex 1/4-28 x 3/4 Gr. 5
STD551125	*Washer, Lock 1/4
1809201	Washer 1/32 x 1-1/4 x 16 Ga.
18091412	Washer 9/32 x 7/8 x 12 Ga.
STD523127	*Bolt, Hex 5/16-18 x 2-3/4
2606J417	Bracket, Engine, R.H.
9173R	Spacer, Split
132212X417	Bracket, Engine, L.H.
STD551131	*Washer, Lock 5/16
STD541031	*Nut, Hex 5/16-18
STD551037	*Washer 13/32 x 13/16 x 11 Ga.
STD551137	*Washer, Lock 3/8
STD541537	*Nut 3/8-24
106391X	Transmission

KEY NO.	PART NO.	DESCRIPTION
15	STD541431	*Nut, Keps 5/16-18
16	STD623732	*Bolt, Hex 3/8-24 x 3-1/4 Gr. 5
17	STD523115	*Bolt, Hex 5/16-18 x 1-1/2
18	131875	Engine, Briggs & Stratton Model No. 60202, Type No. 2219-01
--	110612X	Decal, Caution
--	127862	Decal, Side Shield, 17"
--	12007CX	Decal, Warning
--	132-30	Decal, Engine

*STANDARD HARDWARE--PURCHASE LOCAL
 NOTE: All component dimensions given in U.S. units
 1 inch = 25.4 mm