

## Technical Information

**Subject:** D-Cut Walbro Carburetor

Many Solo units are now equipped with Walbro D-cut style carburetors. The prior use of plastic limiting caps did not always allow optimum re-adjustment of the carburetor. A reduced thread pitch in the D-cut carburetor allows more precise adjustment.

The D-cut carburetors may only be set or re-adjusted by authorized dealers, or service centers with the use of the Solo **D-cut carburetor adjustment tool part # 0080537**. Solo dealers and service centers are required not to pass on or lend the D-cut tool to end users or unauthorized persons.

For replacement purposes, the D-cut carburetors are fully compatible with earlier model carburetors for the same unit.

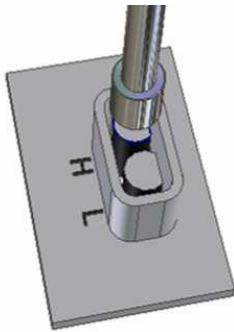

Solo Incorporated  
5100 Chestnut Ave.  
Newport News VA 23605  
757-245-4228 Front Desk  
800-296-7656 Toll Free Technical Services  
757-245-0800 Fax



